

Build a Wall Cabinet with

by George Vondriska

Once you master the techniques involved in building this cabinet the door is open for you to build a variety of items including vanities and bookcases, along with cabinets for your shop or house.

Cutting list

Quant	Part	Dimensions	Material	Notes
2	Case sides	3/4" x 7-1/4" x 28"	Plywood	
2	Top and bottom	3/4" x 7-1/4" x 14-1/4"	Plywood	
2	FF stiles	3/4" x 1-1/2" x 28"	Solid wood	Cut to length after carcass is assembled
2	FF rails	3/4" x 1-1/2" x 15"	Solid wood	Cut to length after carcass is assembled
2	Door stiles	3/4" x 1-1/2" x 25-3/4"	Solid wood	Cut to size after ff is assembled
2	Door rails	3/4" x 1-1/2" x 13-1/2"	Solid wood	Cut to size after ff is assembled
1	Door panel	1/4" x 13-7/16" x 23-7/16"		
2	Screw cleats	3/4" x 2" x 16-1/2"	Plywood	Cut to fit case
1	Back	1/4" x 17-1/4" x 26-3/4"	Plywood	

Door parts formulas

- Length of stiles = height of opening + (2 x overlay)
- Length of rails = width of opening + (2 x overlay) - (2 x stile width) + (2 x tongue length)

Sources

- [Plywood bits](#)
- [Self-closing hinges](#)
- [Tongue and groove router bit set](#)
- [1/4" shelf pins](#)

Kreg tools used

- [Straight Edge Guide](#)
- [Adaptive Cutting System](#)
- [Crosscut Station](#)
- [720 Pro Pocket Hole Jig](#)
- [Shelf Pin Jig with 1/4" bit](#)
- [16" Auto Adjust Clamps](#)
- [Precision Router Table System](#)
- [Precision Router Lift](#)
- [Kreg Precision Set Up Bars](#)

Overall dimensions



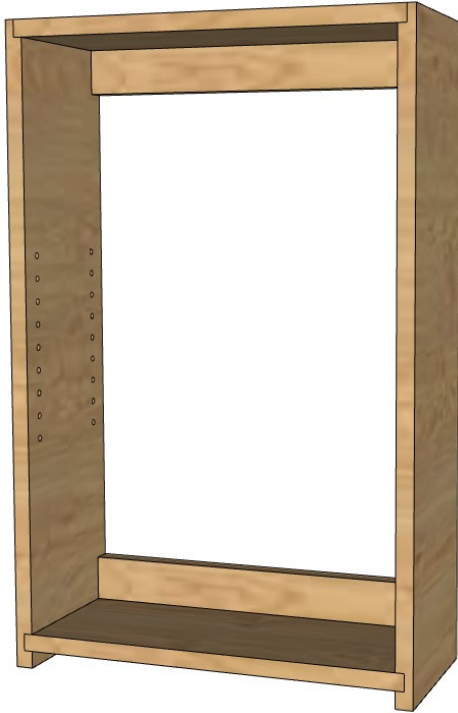

Construction of the cabinet case is very standard with the top captured in a rabbet and the bottom or deck captured in a dado. Two screw cleats in the back of the cabinet provide the rigidity you need to hang the cabinet on a wall. The case sides also include adjustable shelf holes. These are commonly 1/4" or 5 mm diameter to match readily available shelf pins. Center the banks of holes vertically, per the video.

Dado location and joint depth

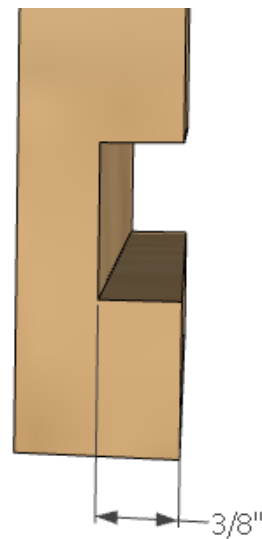
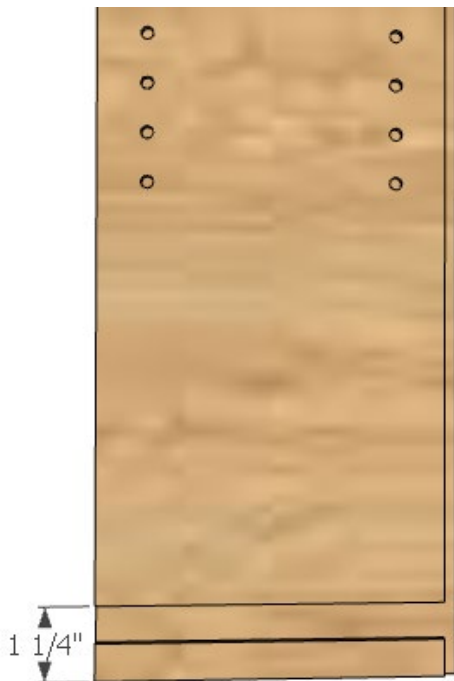

Locating the screw cleats

Make the cleats flush with the rabbets cut for the back



Face frame

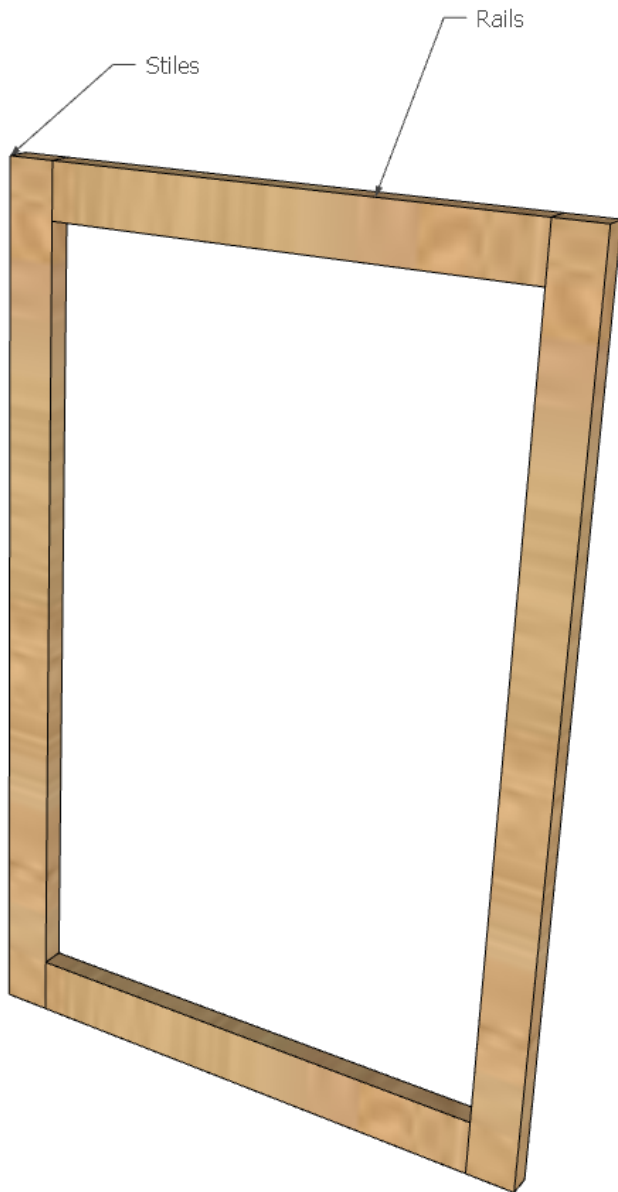

Follow the procedures in the video to custom size the face frame to your carcass.

Use pocket holes joinery, drilled into the rails, to assemble the face frame.

Door

Hinge left or right, depending on your needs for the cabinet.



Use a tongue and groove bit set (See Sources) to create the door joint.

3/8" overlay per side

