

Kid Built Workbench

Here's a great project that, with your help, kids can build for themselves. It's very adaptable so you can make it as simple or complex as the kids want.

Cut List

Quant	Part	Dimensions	Material	Notes
2	Sides	$\frac{3}{4}$ " x 15-1/4" x 28"	Plywood	Pocket hole joinery. Adjust length to change height of bench as needed
1	Divider	$\frac{3}{4}$ " x 15-1/4" x 28"	Plywood	Pocket hole joinery. Adjust length to change height of bench as needed
2	Top and bottom	$\frac{3}{4}$ " x 15-1/4" x 28"	Plywood	
1	Back	$\frac{1}{4}$ " x 28" x 29-1/2"	Plywood	Cut to size after assembling case
1	Shelf	$\frac{3}{4}$ " x 15-1/4" x 12" - 7/8"	Plywood	Cut to size after locating divider
2	Shelf cleats	$\frac{3}{4}$ " x 1-1/2" x 15-1/4"	Plywood	
2	Rear uprights	$\frac{3}{4}$ " x 1-1/4" x 38"	Solid wood	
2	Rear crosspieces	$\frac{3}{4}$ " x 1-1/2" x 25"	Solid wood	Cut to length after assembling case and making uprights. Two pocket holes in each end
1	Pegboard	$\frac{1}{4}$ " x 28" x 32"		
1	Plexi backer	$\frac{1}{4}$ " x 11-1/2" x 15"	Plywood	
1	Plexiglass	$\frac{1}{4}$ " x 11-1/2" x 15"		

Hardware 36 1-1/4" pocket hole screws, 4 2" screws, Casters [Amazon.com](https://www.amazon.com)

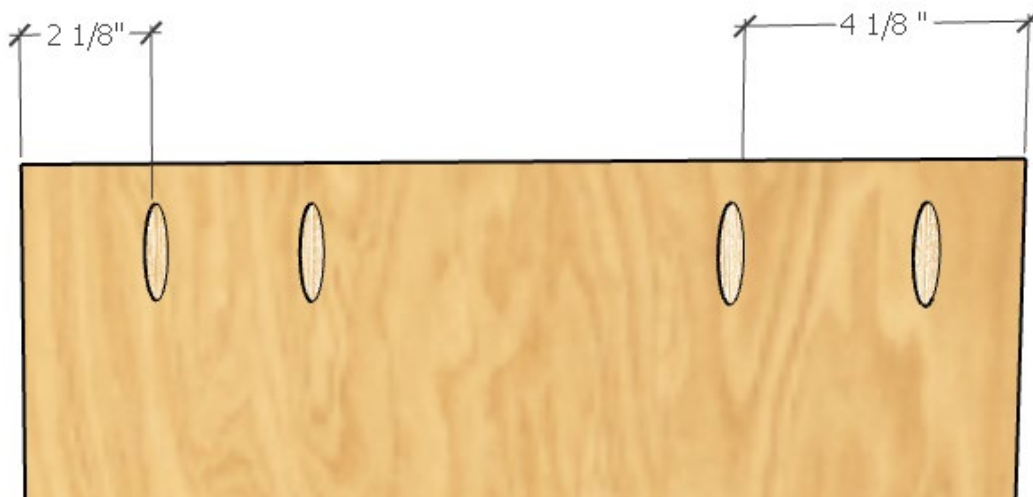

This project relies heavily on pocket hole joinery. Drill four pocket holes in each end of the case sides and divider. The rear frame, which supports the pegboard, also uses pocket hole joinery. You could increase the complexity of this project by using dadoes and rabbets or biscuits for joinery instead of pocket holes. If you want to mask the pocket holes you can fill them with a dowel, typically 3/8" diameter.

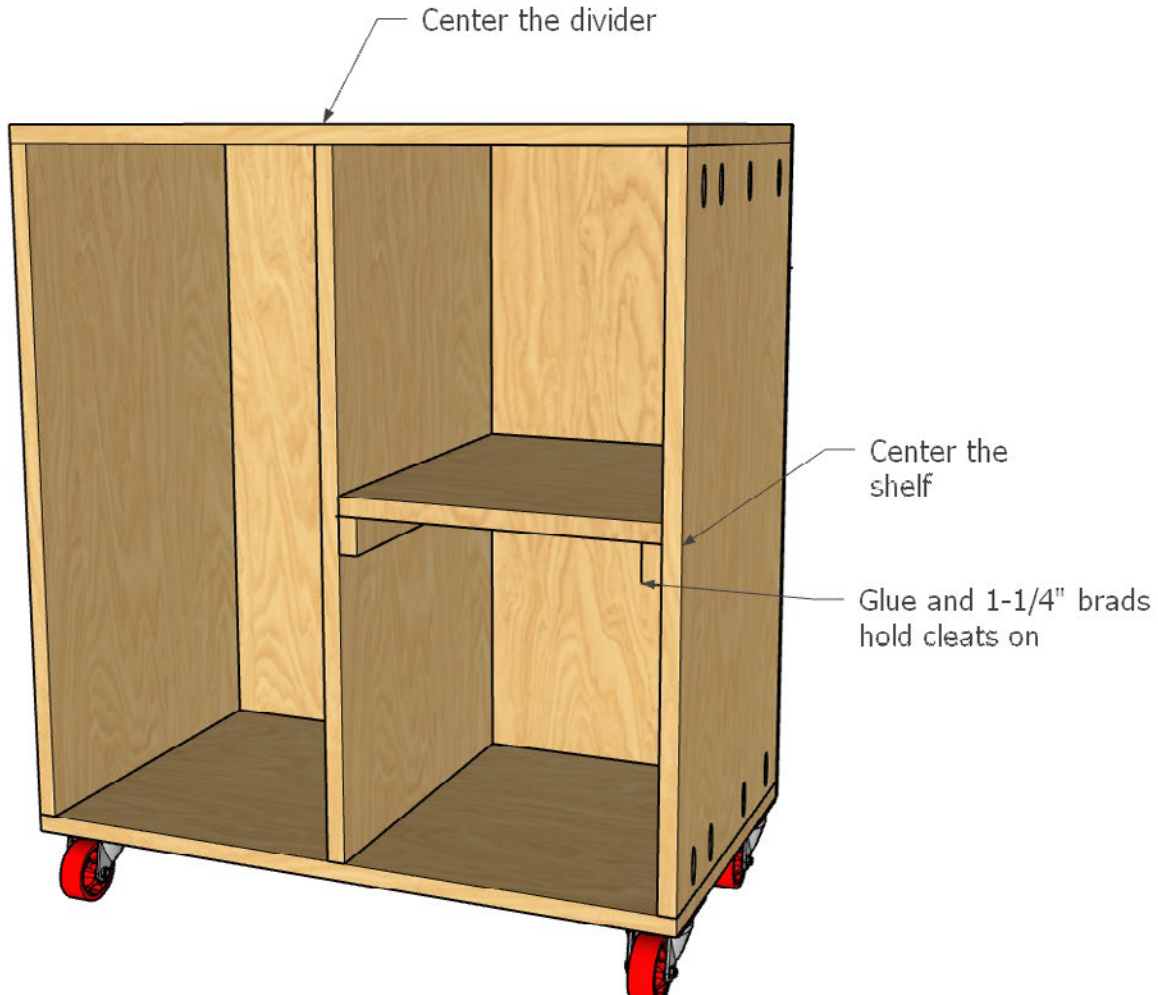

Locate the divider and fixed shelf so they're centered. Add shelves as needed, or change from a fixed shelf to adjustable shelves. Increase the complexity of the project by edge banding the front edges of the plywood or adding a face frame. All five case pieces are the same size, simplifying the cut list for kids.

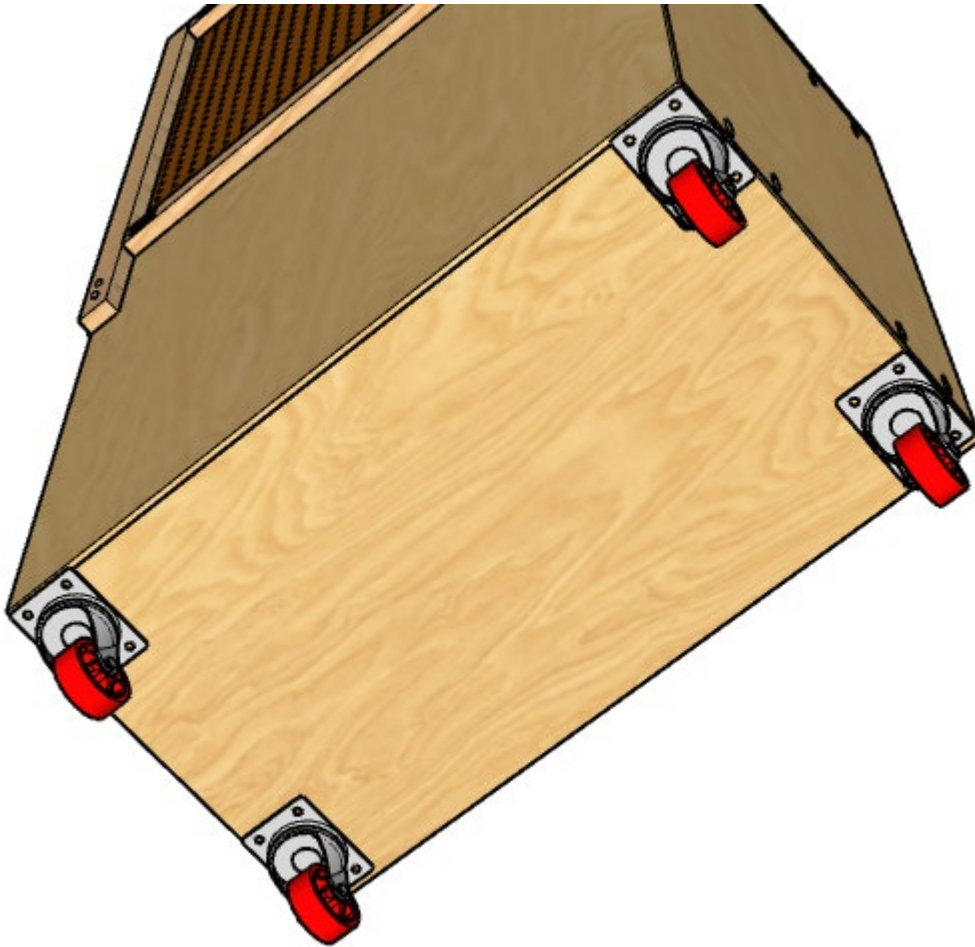

Fasten the casters to the bottom of the case flush with the outside edges.

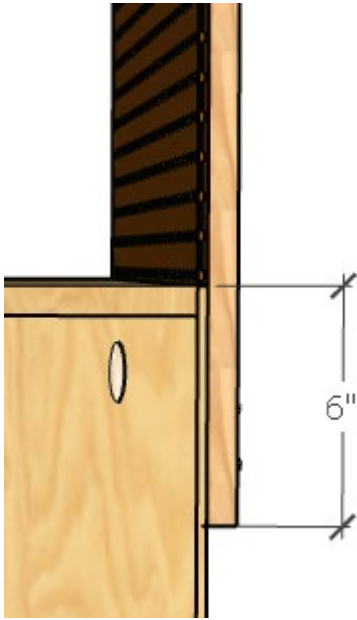

The rear frame overlays the case, allowing you to screw the uprights to the case sides.

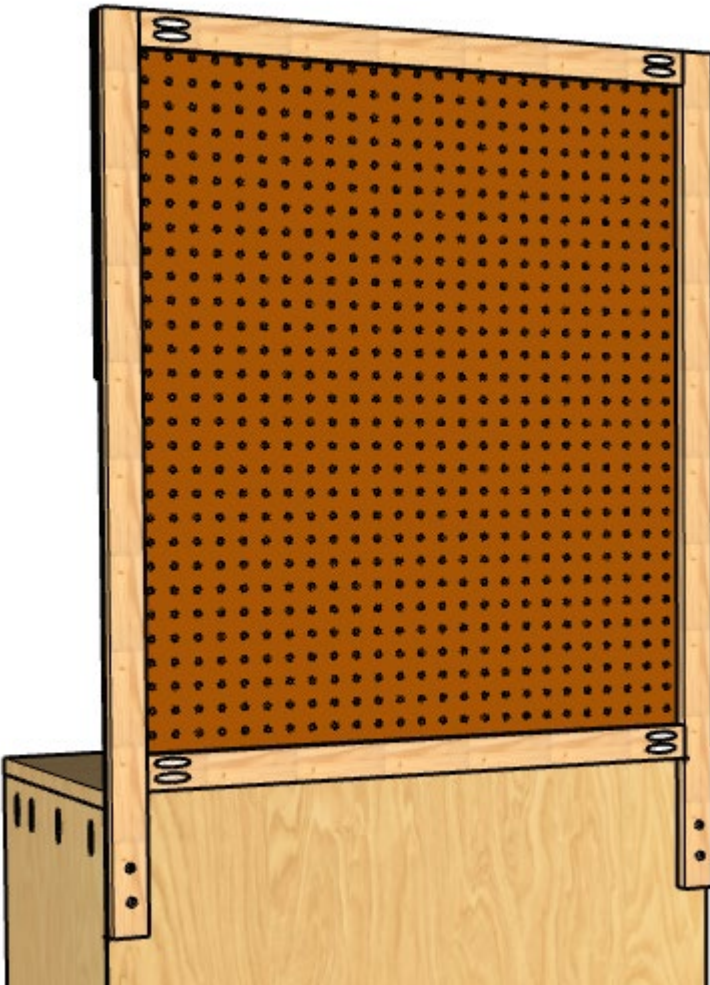

Drill pocket holes in the rear frame cross pieces, and use 2" long screws to fasten the frame to the case. Make sure the screws are going into the case sides, not just the cabinet back.

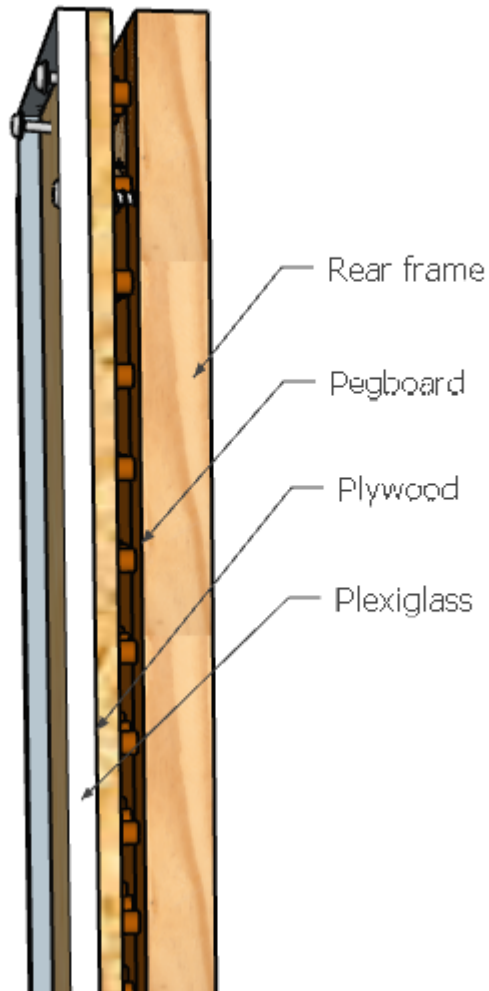

The writing surface “sandwich” is made up of plywood and plexiglass. Alternatively, use a white board.

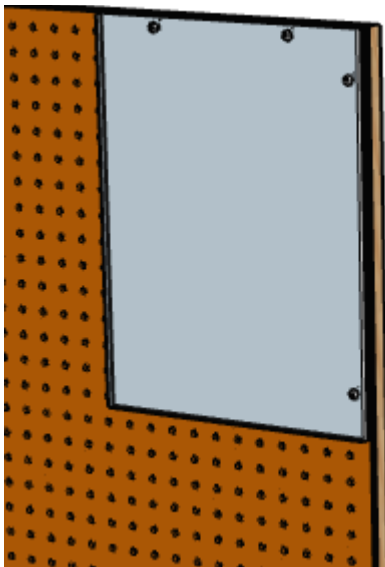

Add screws to hold the writing surface or white board on to the upright back.

[illegible]

To see more great woodworking guides like this, and to watch exclusive project videos, make sure to visit us at www.wwgoa.com. Improve your skills and join our community.